

APPROX.

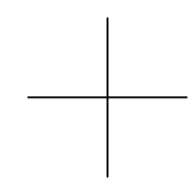

155980.00 N

A1

A2

155970.00 N

B2 ← → B1

A1

A2

B2 ← → B1

356540.00 E

356550.00 E

356560.00 E

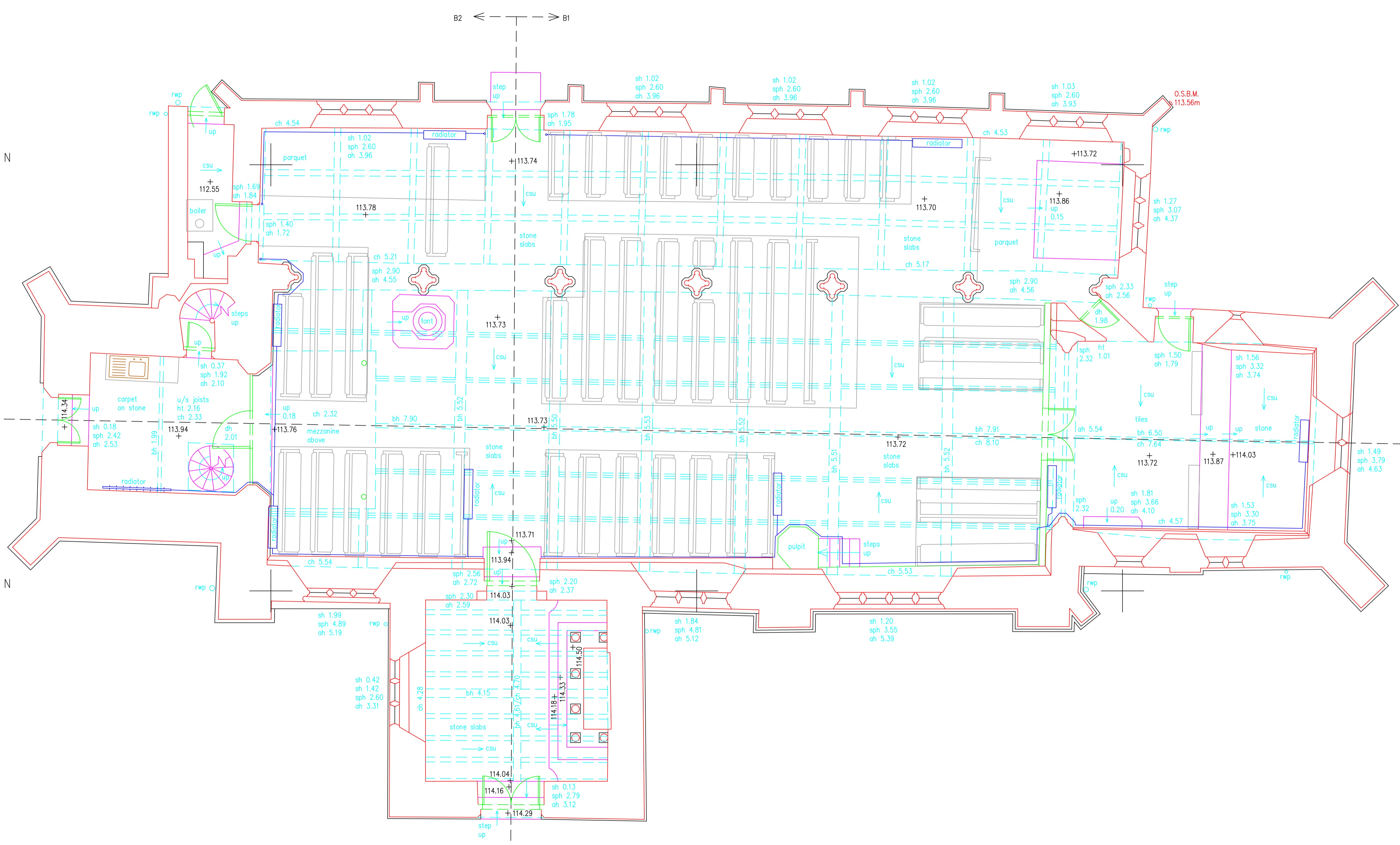

STANDARD REFERENCES

ABBREVIATIONS

ah apex height	il invert level
bh beam height	mh manhole
ch ceiling height	rad radiator
cl cover level	rwp rainwater pipe
csu ceiling slopes up	sh sill height
dh door height	sph spring height
fch false ceiling ht.	svp soil vent pipe
f floor level	utr unable to raise
hh head height	vhh vent head height
ic inspection cover	vp vent pipe
	vsh vent sill height

Notes

1. This survey has been computed and drawn "true to scale" and relates to the OSTN15 GPS National Grid at a single point.
2. All levels are in metres and relate to the mean of the nearest five Ordnance Survey active GPS stations (OSGM15).
3. This survey was measured for a scale of 1:500, any subsequent enlargements should be verified on site.

Revisions

 **Anthony Brookes Surveys Ltd**
LAND, GPS, BUILDING & ENGINEERING SURVEYORS

Unit 2 Thornbury Office Park
Midland Way
Thornbury
Bristol
BS35 2BS
TEL: (01454) 419 133
FAX: (01454) 501 711
e-mail: absurveys@aol.com
web: www.anthonibrookes.com



The copyright in the plans remain vested in Anthony Brookes Surveys Ltd who will grant an irrevocable licence for use by the client upon receipt of full payment. No liability for accuracy shall extend beyond the specified scale of graphical mapping. All services and critical dimensions should be field verified.

Surveyed	Date
Drawn	Checked

Drawing Title **Ground Floor Plan**

Client

Drawing No.	Scale A1 @
	1:50